

EXCEPTIONAL
LEARNING
UTCOMES

ACHIEVE EXCEPTIONAL LEARNING OUTCOMES

In today's world, where the workforce or student body is increasingly dispersed, state-of-the-art hybrid and remote delivery capabilities have become essential.

Hybrid and remote delivery methods offer substantial time/cost savings and reduce the environmental impact by minimizing travel.

However, the challenge lies in whether the quality and learning outcomes of live remote training can match those of face-to-face sessions. Can universities and corporate organizations harness these benefits without compromising the effectiveness of their learning programs? This is a question we are asked all the time.





WHAT'S THE PROBLEM?

There is a perception that it's hard to match the level of engagement and interaction in a hybrid or remote setting compared to a face-to-face session in a real classroom - with real students and teachers. There is also the impression that it is difficult to match the experience of sessions delivered using digital formats. Largely, this is due to user and client experiences using inappropriate technologies and techniques.

OVERCOMING ENGAGEMENT GAPS

When the perceived level of engagement and connection falls short compared to traditional formats, levels of learning outcomes may diminish or even become unattainable. However, this challenge can be overcome by adopting the right tools to deliver high quality, immersive experiences.

TRANSFORMING LEARNING

This is where OneRoom makes a difference. OneRoom is built for learning. Our continuing vision is to build a platform capable of bridging this gap. We collaborate with our customers to design learning spaces that foster **exceptional learning outcomes** for both remote and hybrid learners matching the effectiveness of traditional face-to-face interactions in classrooms or training rooms.



DELIVERING LEARNING EXCELLENCE

To make hybrid and remote learning truly effective, it's essential to implement strategies that boost engagement, participation, and interaction. These tactics should seamlessly blend the strengths of both in-person and online formats, creating an environment where all participants can thrive.

PRACTICAL STRATEGIES FOR SUCCESS



SPATIAL AUDIO

Quickly identify and locate attendees face-to-face



PERSPECTIVE CAMERAS

Give learners their own personal view of the room for higher levels of participation



MULTIPLE CAMERA VIEWS

Deliver a broadcast-like experience to participants with various camera views of the room to support engagement



ZONAL CAMERAS

Enhance visibility for remote attendees by tracking in-room speakers for a more immersive and seamless learning experience



REMOTE USER INTERFACE

Provide a dedicated web-based interface that allows learners to switch between multiple camera views and use a dual screen setup



IN-ROOM USER INTERFACE

Help in-room attendees feel connected and enable easy collaboration and content sharing with their remote peers



HYBRID BREAKOUT GROUPS

Provide dedicated space for discussion combining remote and in-person learners for better understanding and participation



REMOTE PRESENTER

Facilitate sessions from anywhere in the world with full control over content and visibility over all attendees



OneRoom

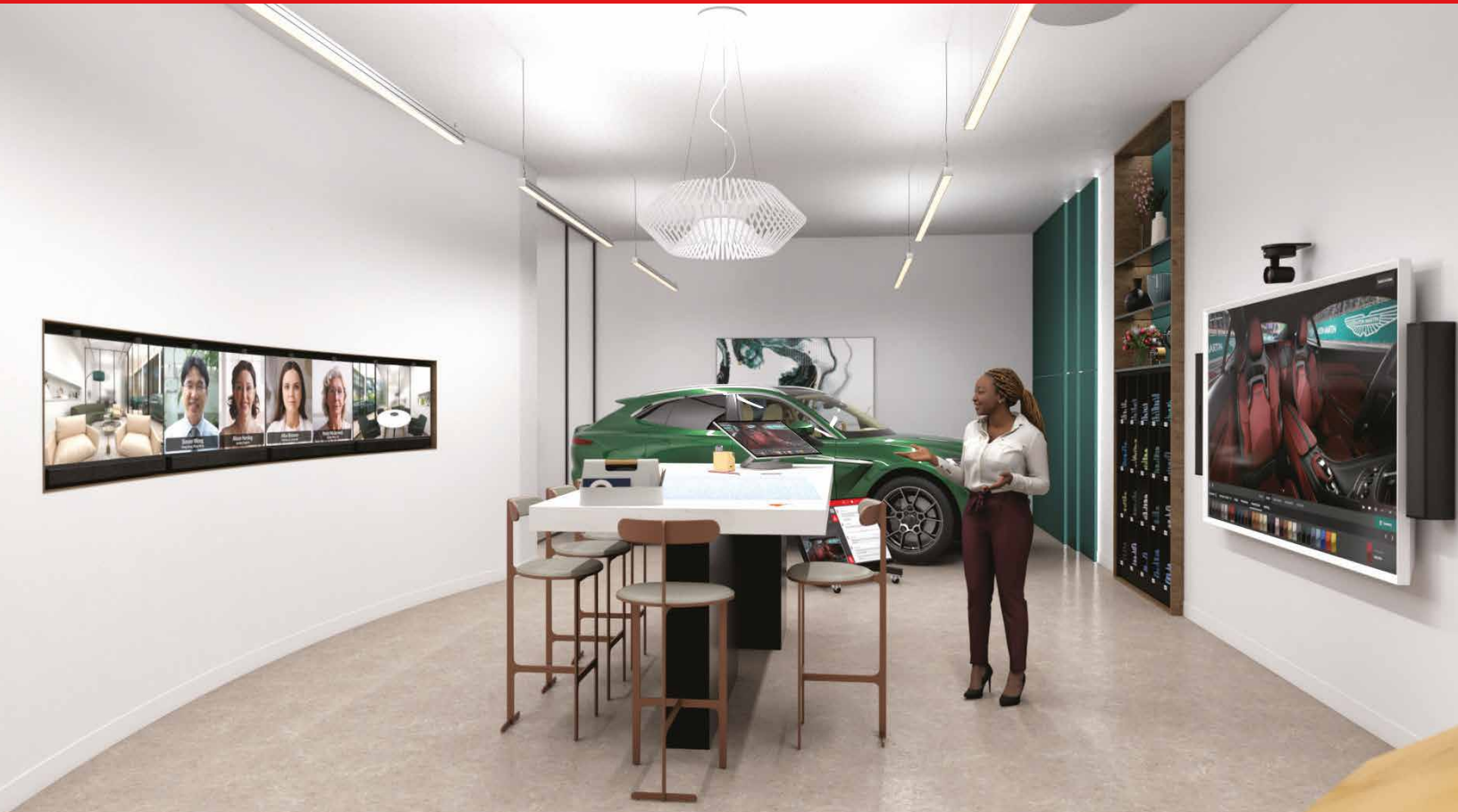

POLLS & QUIZZES

Get instant feedback by using interactive quizzes and polls in a session to gauge engagement and assess learning outcomes



INTERACTIVE WHITEBOARD

Share content that in-room and remote attendees can view for individual or group collaboration and annotation



CONTENT SHARING

Bring sessions to life by sharing documents, files and assets with the group for easy collaboration and annotation



DYNAMIC MEDIA SHARING

Add temporary sources or devices to a session for more in-depth and practical learning including microscopic cameras, AR/VR devices, drones and wearables.



www.x2omedia.com



sales@x2omedia.com

X2O | media

IMMERSIVE SPACES



CUSTOMER TESTIMONIAL

“OneRoom has been used with students and delivered spectacularly on its user experience promise. It adds a layer of interaction that platforms like Teams and Zoom so far lack, particularly with the directional audio and breakout rooms. The lecturers and staff enjoy using the platform and have found X2O support to be extremely responsive.”





“I’ve done nearly 200 events in the last 18 months and this is by far my favourite because of the great connection with the audience... you really feel like you’re in the room with everyone.”



www.x2omedia.com



sales@x2omedia.com

X2O | media



LEARNING SPACES



X2O OneRoom creates unique learning and training spaces with a broadcast-like experience to support corporate organizations and educational institutions with their learning and training delivery.

COMPONENTS FOR LEARNING EXCELLENCE

OneRoom features a participant wall, bringing remote attendees to life as full-sized, in-room participants. This ensures that those joining remotely have a tangible presence in the physical space, allowing them to be seen and heard on equal footing with in-person attendees. It's a seamless blend of physical and virtual interaction, redefining the hybrid experience.

Remote participants enjoy a virtual seat in the room, interacting through a dedicated user interface with multiple camera views and collaboration tools. Directional audio ensures in-room attendees can easily identify and engage with remote speakers for seamless interaction.



www.x2omedia.com



sales@x2omedia.com

X2O | media



AI INSIGHT & SUPPORT

OneRoom is at the forefront of innovation, leveraging AI technology to empower instructors and enhance the learning experience. Its AI engine supports every phase of a session, from suggesting content and creating assets beforehand to providing real-time feedback on learner progress and engagement during the session. Post-session, the AI delivers valuable insights to refine course design and content, ensuring continuous improvement.

SEAMLESS INTEGRATION

OneRoom provides full training visibility and is versatile enough for soft skills, technical training, assessments, inductions, and even hands-on practical sessions. It integrates seamlessly with Learning Management Systems (LMS).



DATA-DRIVEN INSIGHTS

These are key to measuring learning outcomes, and OneRoom's analytics dashboard delivers just that. Instructors can track engagement levels, participant activity, and session usage, equipping them with the tools to optimize learning experiences like never before.



CUSTOMER TESTIMONIAL

"The delegates found the experience incredibly engaging, with 100% rating it substantially better than any other online learning format they had encountered.

As a trainer I appreciated the two-way connection and responsiveness that is often lacking in standard online training"



OneRoom **CONNECTED SPACES**



OneRoom supports dual-purpose spaces that function independently or as part of a connected network across campuses or offices with its Connected Spaces.

Seamlessly connect multiple rooms to foster collaboration and empower learners to engage and contribute from any location. The flexible and scalable Connected Spaces approach integrates rooms of varying sizes, extending the reach and effectiveness of learning sessions.

Within a Connected Space, Huddle Rooms or Breakout Pods can be used to bring learners together.

HUDDLE ROOMS

These are customizable to any space and are typically designed for up to 8 people. They enable in-room attendees to join a OneRoom session using a purpose-built interface with integrated controls, audio and advanced camera setups.





BREAKOUT PODS

When triggering Breakout mode in a OneRoom session, OneRoom creates numerous new breakout rooms each with their own audio and video channels and whiteboard.

Remote participants are then assigned to a particular Breakout Pod and joined physically by in-room attendees.



Breakout Pods can be built to any size but typically hold no more than 8 people and include a purpose built user interface. The instructor can engage both sets of participants from either the main OneRoom or within the physical pod.



OneRoom LINKED SPACES

OneRoom Linked Spaces extends traditional learning environments by enabling a seamless transition between a teaching room and a practical training area.

With Linked Spaces, sessions are conducted across two separate rooms: one dedicated to teaching and theoretical knowledge, and the other designed for hands-on practical training.

A session may begin in the teaching room, focusing on the instructor-led delivery of concepts and skill-setting, before transitioning to the practical space for deeper, experiential learning.

Participants in the physical teaching room can move freely between spaces, while remote attendees remain seamlessly connected throughout the session without interruption. This innovative approach ensures a cohesive and engaging learning experience for all, regardless of location.

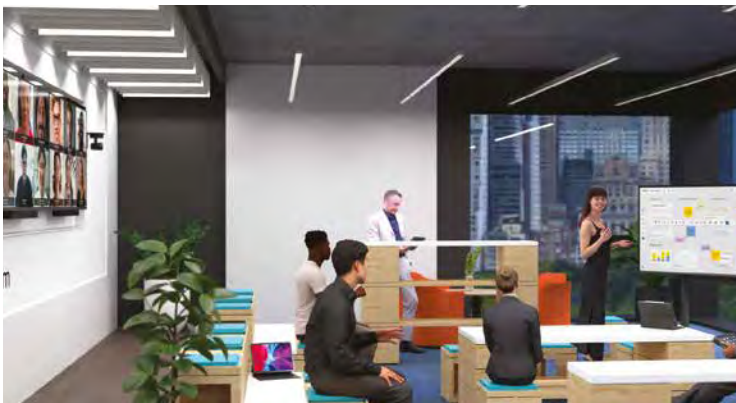

TEACHING ROOM

The first room is a teaching room setup for a hybrid learning session with both in-room and remote attendees.

This scenario is ideal for theoretical knowledge and skills development.

TEACHING ROOM - USER INTERFACE

Participants have their own unique view of the teaching room in their UI along with multiple camera views and can interact with other attendees and instructors.



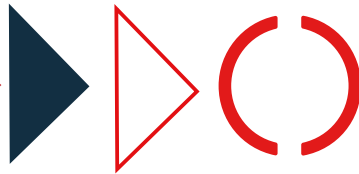

PRACTICAL SPACE

Attendees in the session transition to a second room which may contain physical equipment or machinery to support the theory and skills learnt in the teaching room. Multiple camera views allow remote participants to see details closely.

PRACTICAL SPACE USER INTERFACE

Remote attendees remain in the same session and will see their UI update to reflect the new camera views of the practical space. The experience continues in the same way with access to content and tools while enabling collaboration with in-room attendees.



OneRoom EXPERIENCE SPACES

Expanding on the Linked Spaces offering, X2O OneRoom can work alongside X2O OneVu to transform multiple spaces into an immersive environment that guides physical visitors through curated journeys, enabling interactive learning, collaborative workshops, and engaging product showcases.

IMMERSIVE CONNECTIONS FOR REMOTE VISITORS

X2O OneRoom revolutionizes the remote visitor experience, allowing participants to seamlessly join the journey and explore different zones through the X2O web interface.

Remote attendees are represented as life-size figures on in-room displays, creating a powerful sense of presence and connection within the physical space.

Through the X2O interface, users can access multiple strategically positioned cameras for dynamic room perspectives, enhancing engagement. Additionally, participants can view content both on the remote user interface and on displays within the physical room, ensuring an immersive and interactive experience.

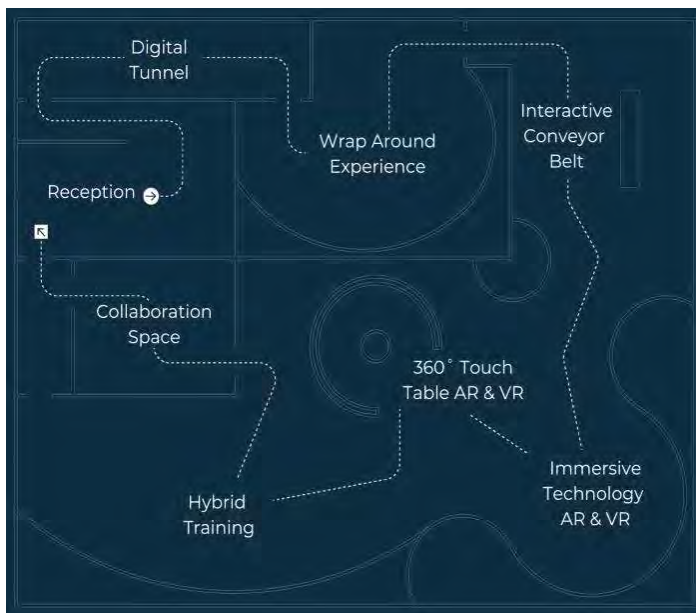

Example above shows how a journey can be split into multiple zones

POWERFUL COMBINATION

Experience Spaces use X2O OneVu, a digital signage application, to provide real-time visual digital experiences which can be seen on physical displays in each zone or space on the journey.

OneVu, combined with the power of OneRoom, amplifies the entire experience for remote attendees, and brings them into the same environment for the same level of interaction, creating dynamic engagements that connect and inspire.





Experience Spaces are a unique proposition combining two powerful technologies, X2O OneRoom and X2O OneVu.

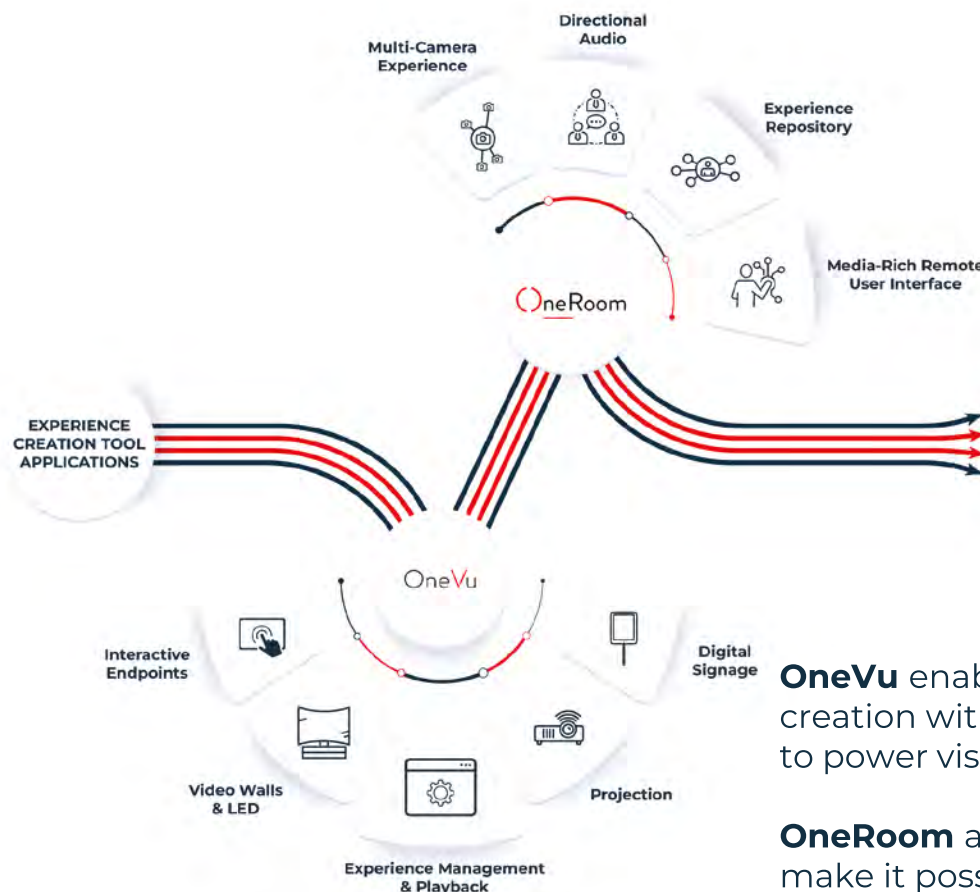

OneVu enables dynamic content creation with its tools and applications to power visual digital experiences.

OneRoom amplifies the experience to make it possible for people to join remotely and benefit from the same experience as if they were in the room alongside the physical attendees.



www.x2omedia.com



sales@x2omedia.com

X2O | media



X₂0 | media
A **STRATACACHE** COMPANY

www.x20media.com